

# Trench Schottky Rectifier, Low Forward Voltage

## NTSA4100, NRV TSA4100

### Features

- Fine Lithography Trench-based Schottky Technology for Very Low Forward Voltage and Low Leakage
- Fast Switching with Exceptional Temperature Stability
- Low Power Loss and Lower Operating Temperature
- Higher Efficiency for Achieving Regulatory Compliance
- High Surge Capability
- NRV TSA Prefix for Automotive and Other Applications Requiring Unique Site and Control Change Requirements; AEC-Q101 Qualified and PPAP Capable
- These Devices are Pb-Free, Halogen Free/BFR Free and are RoHS Compliant

### Typical Applications

- Switching Power Supplies including Wireless, Smartphone and Notebook Adapters
- High Frequency and DC-DC Converters
- Freewheeling and OR-ing diodes
- Reverse Battery Protection
- Instrumentation
- LED Lighting

### Mechanical Characteristics:

- Case: Epoxy, Molded
- Epoxy Meets Flammability Rating UL 94-0 @ 0.125 in.
- Lead Finish: 100% Matte Sn (Tin)
- Lead and Mounting Surface Temperature for Soldering Purposes: 260°C Max. for 10 Seconds
- Device Meets MSL 1 Requirements

## SCHOTTKY BARRIER RECTIFIERS 4 AMPERES 100 VOLTS



SMA  
 CASE 403D  
 STYLE 1

### MARKING DIAGRAM



- TH41 = Specific Device Code
- A = Assembly Location
- Y = Year
- WW = Work Week
- = Pb-Free Package

(Note: Microdot may be in either location)

### ORDERING INFORMATION

See detailed ordering and shipping information in the package dimensions section on page 4 of this data sheet.

# NTSA4100, NRV TSA4100

## MAXIMUM RATINGS

| Rating                                                                                                      | Symbol                          | Value       | Unit             |
|-------------------------------------------------------------------------------------------------------------|---------------------------------|-------------|------------------|
| Peak Repetitive Reverse Voltage<br>Working Peak Reverse Voltage<br>DC Blocking Voltage                      | $V_{RRM}$<br>$V_{RWM}$<br>$V_R$ | 100         | V                |
| Average Rectified Forward Current<br>( $T_L = 118^\circ\text{C}$ )                                          | $I_{F(AV)}$                     | 4.0         | A                |
| Peak Repetitive Forward Current,<br>(Square Wave, 20 kHz, $T_L = 110^\circ\text{C}$ )                       | $I_{FRM}$                       | 8.0         | A                |
| Non-Repetitive Peak Surge Current<br>(Surge Applied at Rated Load Conditions Halfwave, Single Phase, 60 Hz) | $I_{FSM}$                       | 50          | A                |
| Storage Temperature Range                                                                                   | $T_{stg}$                       | -65 to +150 | $^\circ\text{C}$ |
| Operating Junction Temperature                                                                              | $T_J$                           | -55 to +150 | $^\circ\text{C}$ |
| ESD Rating (Human Body Model)                                                                               |                                 | 1B          |                  |
| ESD Rating (Charged Device Model)                                                                           |                                 | > 1000      | V                |

Stresses exceeding those listed in the Maximum Ratings table may damage the device. If any of these limits are exceeded, device functionality should not be assumed, damage may occur and reliability may be affected.

## THERMAL CHARACTERISTICS

| Characteristic                                                                                                               | Symbol          | Typ | Max  | Unit                      |
|------------------------------------------------------------------------------------------------------------------------------|-----------------|-----|------|---------------------------|
| Thermal Resistance, Junction-to-Lead, Steady State<br>(Assumes 600 mm <sup>2</sup> 1 oz. copper bond pad, on a FR4 board)    | $R_{\theta JL}$ | -   | 16.2 | $^\circ\text{C}/\text{W}$ |
| Thermal Resistance, Junction-to-Ambient, Steady State<br>(Assumes 600 mm <sup>2</sup> 1 oz. copper bond pad, on a FR4 board) | $R_{\theta JA}$ | -   | 90   | $^\circ\text{C}/\text{W}$ |

## ELECTRICAL CHARACTERISTICS

|                                                                                                                                                                                                                                                                          |       |                                  |                            |                     |
|--------------------------------------------------------------------------------------------------------------------------------------------------------------------------------------------------------------------------------------------------------------------------|-------|----------------------------------|----------------------------|---------------------|
| Instantaneous Forward Voltage (Note 1)<br>( $i_F = 1.0\text{ A}$ , $T_J = 25^\circ\text{C}$ )<br>( $i_F = 4.0\text{ A}$ , $T_J = 25^\circ\text{C}$ )<br><br>( $i_F = 1.0\text{ A}$ , $T_J = 125^\circ\text{C}$ )<br>( $i_F = 4.0\text{ A}$ , $T_J = 125^\circ\text{C}$ ) | $v_F$ | 0.43<br>0.59<br><br>0.35<br>0.53 | -<br>0.66<br><br>-<br>0.58 | V                   |
| Reverse Current (Note 1)<br>(Rated dc Voltage, $T_J = 25^\circ\text{C}$ )<br>(Rated dc Voltage, $T_J = 125^\circ\text{C}$ )                                                                                                                                              | $i_R$ | 1.3<br>0.13                      | 25<br>9                    | $\mu\text{A}$<br>mA |
| Diode Capacitance<br>(Rated dc Voltage, $T_J = 25^\circ\text{C}$ , $f = 1\text{ MHz}$ )                                                                                                                                                                                  | $C_d$ | 54.7                             |                            | pF                  |

Product parametric performance is indicated in the Electrical Characteristics for the listed test conditions, unless otherwise noted. Product performance may not be indicated by the Electrical Characteristics if operated under different conditions.

1. Pulse Test: Pulse Width = 300  $\mu\text{s}$ , Duty Cycle  $\leq 2.0\%$ .

# NTSA4100, NRV TSA4100

## TYPICAL CHARACTERISTICS

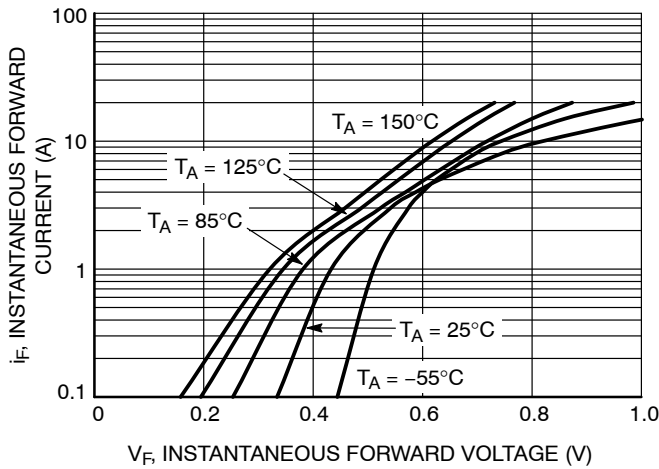

**Figure 1. Typical Instantaneous Forward Characteristics**

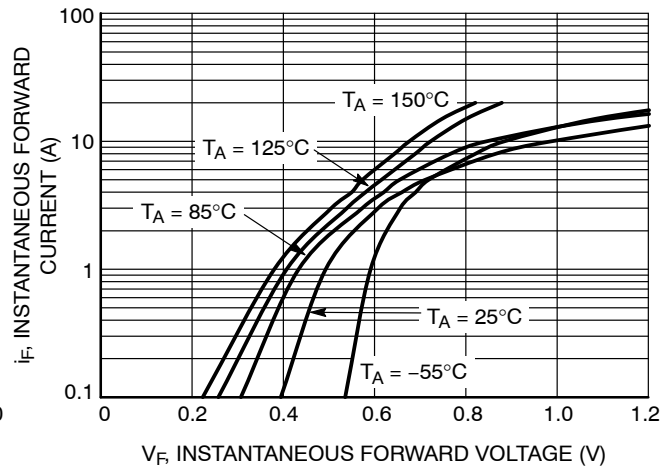

**Figure 2. Maximum Instantaneous Forward Characteristics**

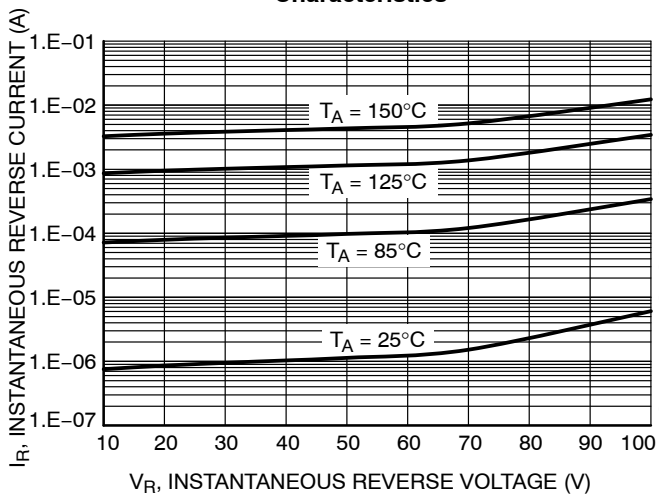

**Figure 3. Typical Reverse Characteristics**

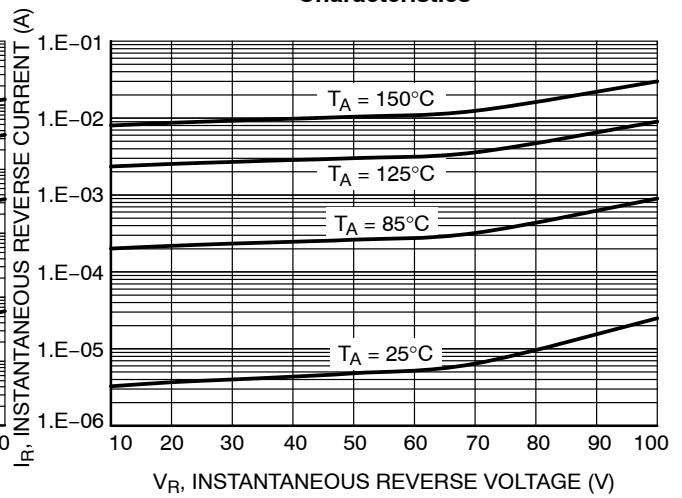

**Figure 4. Maximum Reverse Characteristics**

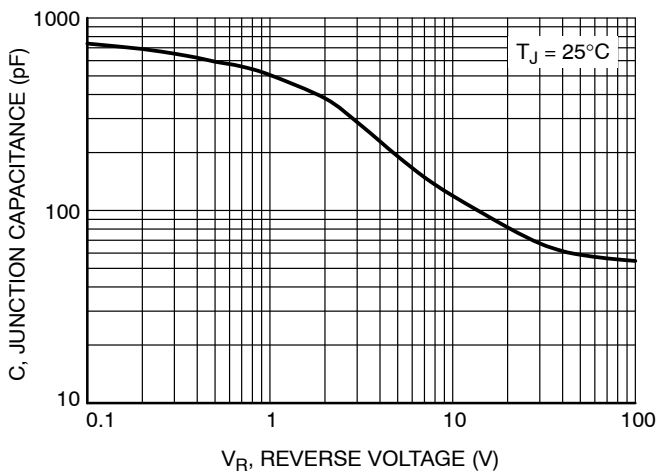

**Figure 5. Typical Junction Capacitance**

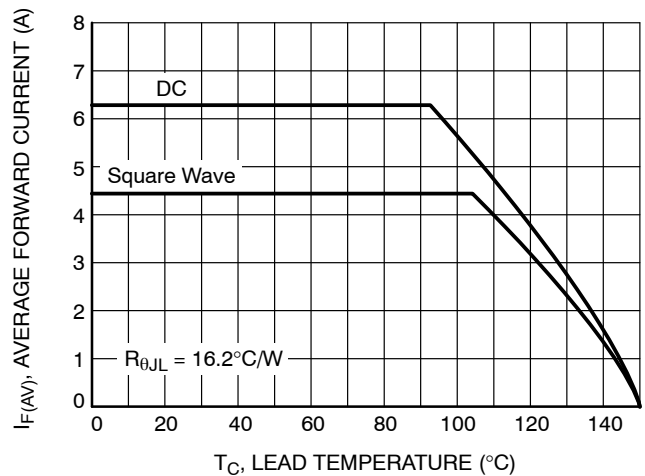

**Figure 6. Current Derating**

# NTSA4100, NRV TSA4100

## TYPICAL CHARACTERISTICS

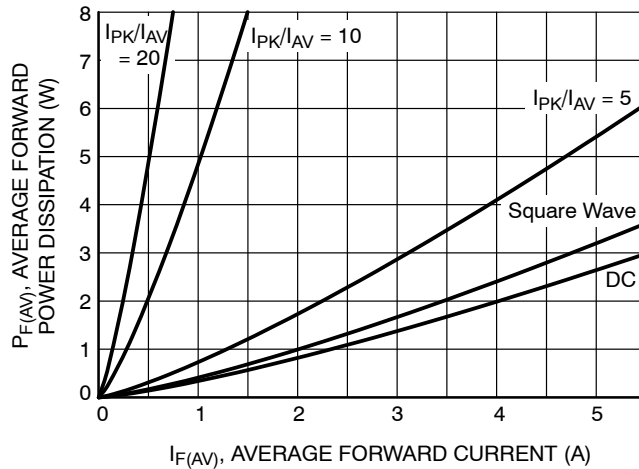

Figure 7. Forward Power Dissipation

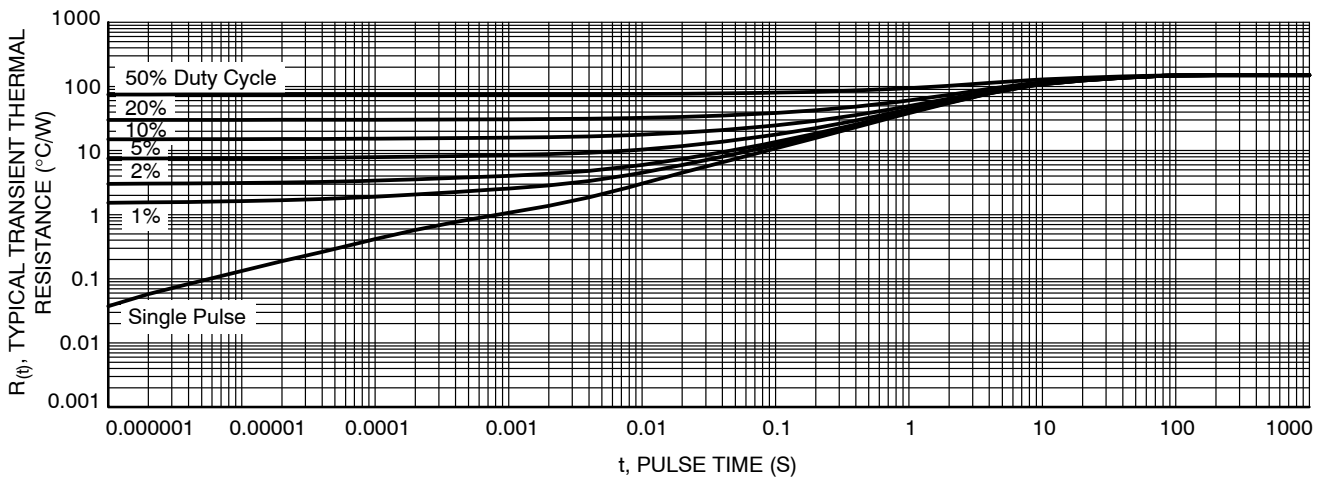

Figure 8. Typical Transient Thermal Response, Junction-to-Ambient

### ORDERING INFORMATION

| Device              | Package          | Shipping <sup>†</sup> |
|---------------------|------------------|-----------------------|
| NTSA4100T3G         | SMA<br>(Pb-Free) | 5000 /<br>Tape & Reel |
| NRV TSA4100T3G      | SMA<br>(Pb-Free) | 5000 /<br>Tape & Reel |
| NRV TSA4100T3G-GA01 | SMA<br>(Pb-Free) | 5000 /<br>Tape & Reel |

<sup>†</sup>For information on tape and reel specifications, including part orientation and tape sizes, please refer to our Tape and Reel Packaging Specifications Brochure, [BRD8011/D](#).

# MECHANICAL CASE OUTLINE PACKAGE DIMENSIONS



STYLE 1    STYLE 2

SCALE 1:1

**SMA**  
CASE 403D  
ISSUE J

DATE 22 OCT 2021



POLARITY INDICATOR  
OPTIONAL AS NEEDED

NOTES:

1. DIMENSIONING AND TOLERANCING PER ANSI Y14.5M, 1982.
2. CONTROLLING DIMENSION: INCHES
3. DIMENSION *b* SHALL BE MEASURED WITHIN DIMENSION L.

| DIM      | MILLIMETERS |      |      | INCHES |       |       |
|----------|-------------|------|------|--------|-------|-------|
|          | MIN.        | NOM. | MAX. | MIN.   | NOM.  | MAX.  |
| A        | 1.97        | 2.10 | 2.20 | 0.078  | 0.083 | 0.087 |
| A1       | 0.05        | 0.10 | 0.20 | 0.002  | 0.004 | 0.008 |
| <i>b</i> | 1.27        | 1.45 | 1.63 | 0.050  | 0.057 | 0.064 |
| <i>c</i> | 0.15        | 0.28 | 0.41 | 0.006  | 0.011 | 0.016 |
| D        | 2.29        | 2.60 | 2.92 | 0.090  | 0.103 | 0.115 |
| E        | 4.06        | 4.32 | 4.57 | 0.160  | 0.170 | 0.180 |
| HE       | 4.83        | 5.21 | 5.59 | 0.190  | 0.205 | 0.220 |
| L        | 0.76        | 1.14 | 1.52 | 0.030  | 0.045 | 0.060 |



STYLE 1:  
PIN 1. CATHODE (POLARITY BAND)  
2. ANODE

STYLE 2:  
NO POLARITY

**GENERIC  
MARKING DIAGRAM\***



STYLE 1

STYLE 2

- xxxx = Specific Device Code
- A = Assembly Location
- Y = Year
- WW = Work Week
- = Pb-Free Package

\*This information is generic. Please refer to device data sheet for actual part marking. Pb-Free indicator, "G" or microdot "▪", may or may not be present. Some products may not follow the Generic Marking.

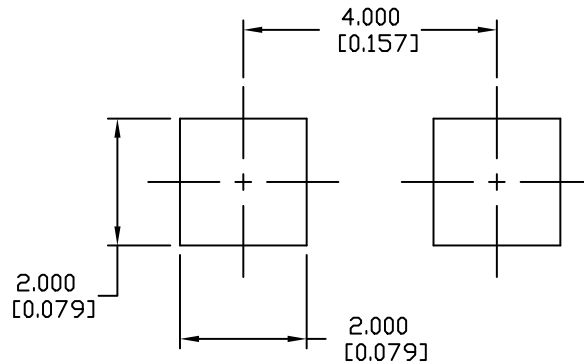

RECOMMENDED  
MOUNTING FOOTPRINT

|                         |                    |                                                                                                                                                                                  |
|-------------------------|--------------------|----------------------------------------------------------------------------------------------------------------------------------------------------------------------------------|
| <b>DOCUMENT NUMBER:</b> | <b>98AON04079D</b> | Electronic versions are uncontrolled except when accessed directly from the Document Repository. Printed versions are uncontrolled except when stamped "CONTROLLED COPY" in red. |
| <b>DESCRIPTION:</b>     | <b>SMA</b>         | <b>PAGE 1 OF 1</b>                                                                                                                                                               |

onsemi and ONSEMI are trademarks of Semiconductor Components Industries, LLC dba onsemi or its subsidiaries in the United States and/or other countries. onsemi reserves the right to make changes without further notice to any products herein. onsemi makes no warranty, representation or guarantee regarding the suitability of its products for any particular purpose, nor does onsemi assume any liability arising out of the application or use of any product or circuit, and specifically disclaims any and all liability, including without limitation special, consequential or incidental damages. onsemi does not convey any license under its patent rights nor the rights of others.

**onsemi**, **Onsemi**, and other names, marks, and brands are registered and/or common law trademarks of Semiconductor Components Industries, LLC dba "**onsemi**" or its affiliates and/or subsidiaries in the United States and/or other countries. **onsemi** owns the rights to a number of patents, trademarks, copyrights, trade secrets, and other intellectual property. A listing of **onsemi**'s product/patent coverage may be accessed at [www.onsemi.com/site/pdf/Patent-Marking.pdf](http://www.onsemi.com/site/pdf/Patent-Marking.pdf). **onsemi** reserves the right to make changes at any time to any products or information herein, without notice. The information herein is provided "as-is" and **onsemi** makes no warranty, representation or guarantee regarding the accuracy of the information, product features, availability, functionality, or suitability of its products for any particular purpose, nor does **onsemi** assume any liability arising out of the application or use of any product or circuit, and specifically disclaims any and all liability, including without limitation special, consequential or incidental damages. Buyer is responsible for its products and applications using **onsemi** products, including compliance with all laws, regulations and safety requirements or standards, regardless of any support or applications information provided by **onsemi**. "Typical" parameters which may be provided in **onsemi** data sheets and/or specifications can and do vary in different applications and actual performance may vary over time. All operating parameters, including "Typicals" must be validated for each customer application by customer's technical experts. **onsemi** does not convey any license under any of its intellectual property rights nor the rights of others. **onsemi** products are not designed, intended, or authorized for use as a critical component in life support systems or any FDA Class 3 medical devices or medical devices with a same or similar classification in a foreign jurisdiction or any devices intended for implantation in the human body. Should Buyer purchase or use **onsemi** products for any such unintended or unauthorized application, Buyer shall indemnify and hold **onsemi** and its officers, employees, subsidiaries, affiliates, and distributors harmless against all claims, costs, damages, and expenses, and reasonable attorney fees arising out of, directly or indirectly, any claim of personal injury or death associated with such unintended or unauthorized use, even if such claim alleges that **onsemi** was negligent regarding the design or manufacture of the part. **onsemi** is an Equal Opportunity/Affirmative Action Employer. This literature is subject to all applicable copyright laws and is not for resale in any manner.

## ADDITIONAL INFORMATION

### TECHNICAL PUBLICATIONS:

Technical Library: [www.onsemi.com/design/resources/technical-documentation](http://www.onsemi.com/design/resources/technical-documentation)  
onsemi Website: [www.onsemi.com](http://www.onsemi.com)

### ONLINE SUPPORT: [www.onsemi.com/support](http://www.onsemi.com/support)

For additional information, please contact your local Sales Representative at [www.onsemi.com/support/sales](http://www.onsemi.com/support/sales)